

**Springer Table of Figures**

**Figure 1:** Sierra Vista Zoning Map

**Figure 2:** Distance from the Speed Limit Sign to Intersection

**Figure 3:** Eastwardly view of the distance from speed limit sign to the intersection

**Figure 3.1:** Distance Intersection to Gate

**Figure 4:** Distance from crosswalk at Fry and Winrow to the first posted sign

**Figure 4.1:** First sign up close- Gate Hours of Operation

**Figure 5:** Second Sign- LEOSA permits not authorized, gun restriction

**Figure 6:** Third sign – 1<sup>st</sup> Warning Signs.

**Figure 7:** Fourth Sign -Hands Free Cell Phone Sign

**Figure 8:** Required sign per *Army Regulation 190–13, The Army Physical Security Program* Figure 6–1.

**Figure 8.1:** Required signs along the perimeter per Figure 6-2

**Figure 9:** Visitor Packet Map

**Figure 10:** Distance from Buffalo Gate to Van Deman Gate, where the no photography sign is posted

**Figure 1:** Sierra Vista Zoning Map

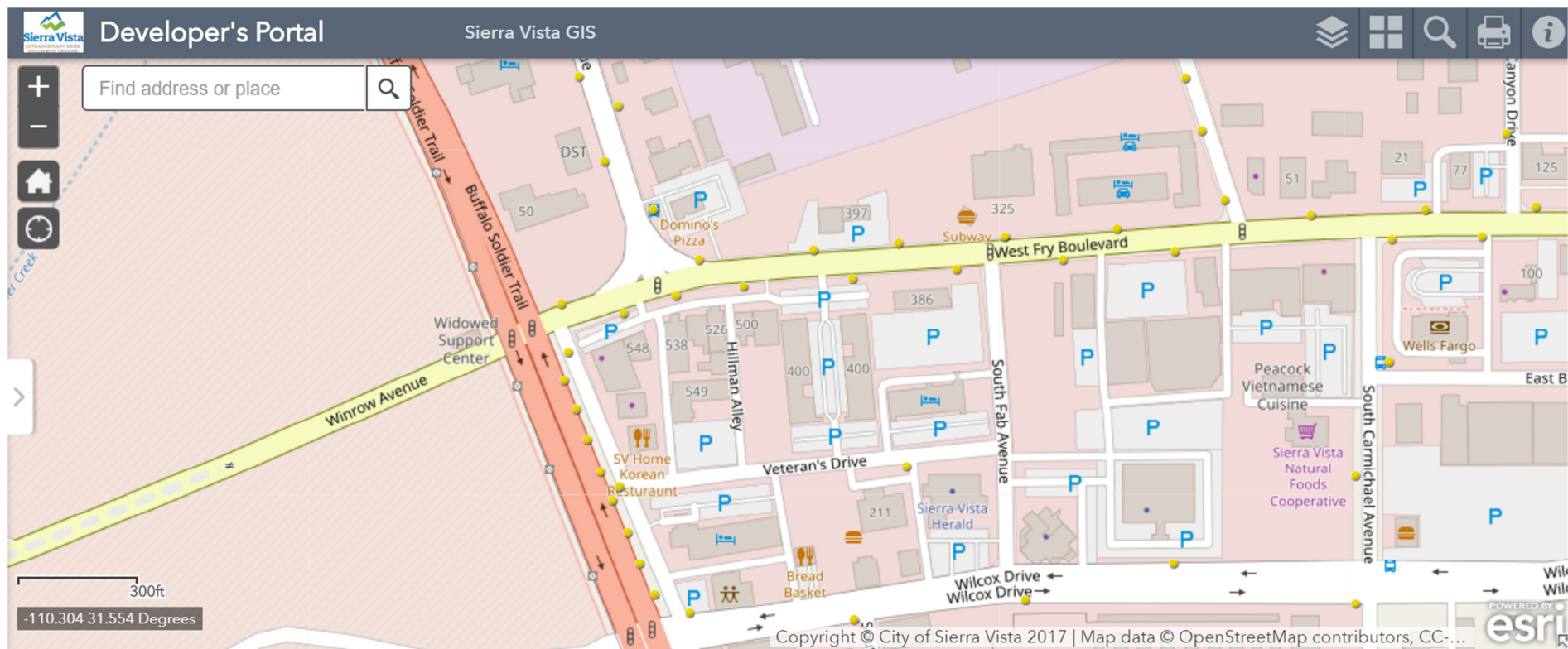

**Figure 2:** Distance from the Speed Limit Sign to Intersection



**Figure 3:** Eastwardly view of the distance from speed limit sign to the intersection





**Figure 3.1:** Distance Intersection to Gate



**Figure 4:** Distance from crosswalk at Fry and Winrow to the first posted sign





**Figure 4.1:** First sign up close- Gate Hours of Operation



**Figure 5:** Second Sign- LEOSA permits not authorized, gun restriction





**Figure 6:** Third sign – 1<sup>st</sup> Warning Signs.





**Figure 7:** Fourth Sign -Hands Free Cell Phone Sign



**Figure 8:** Required sign per *Army Regulation 190–13, The Army Physical Security Program* Figure 6–1.

---

**WARNING**

**RESTRICTED AREA**

**THIS (INSTALLATION, ACTIVITY, ETC.) HAS BEEN DECLARED A  
RESTRICTED AREA BY AUTHORITY OF THE COMMANDER IN  
ACCORDANCE WITH THE PROVISIONS OF THE DIRECTIVE  
ISSUED BY THE SECRETARY OF DEFENSE, PURSUANT TO THE  
PROVISIONS OF SECTION 21, INTERNAL SECURITY ACT OF 1950.**

**UNAUTHORIZED ENTRY IS PROHIBITED**

**ALL PERSONS AND VEHICLES ENTERING HEREIN ARE LIABLE  
TO SEARCH. PHOTOGRAPHING OR MAKING NOTES, DRAWINGS,  
MAPS, OR GRAPHIC REPRESENTATIONS OF THIS AREA OR ITS  
ACTIVITIES ARE PROHIBITED UNLESS SPECIFICALLY  
AUTHORIZED BY THE COMMANDER. ANY SUCH MATERIAL  
FOUND IN THE POSSESSION OF UNAUTHORIZED PERSONS  
WILL BE CONFISCATED.**

---

Figure 6-1. Warning sign for installation IACPs and facility entry control points

---

**Figure 8.1:** Required signs along the perimeter per Figure 6-2



(2) Signs will be posted per figure 6–2 along property perimeters in sufficient numbers so the warning can be readily seen and understood by approaching persons.

---

**WARNING**  
**RESTRICTED AREA**  
**KEEP OUT**  
**AUTHORIZED PERSONNEL ONLY**

Figure 6–2. Warning sign for property perimeters

---

(3) Both warnings notices will be posted in English. For OCONUS, the warning notices will also be posted in the host-nation language. For both continental United States (CONUS) and OCONUS, the warning notice is also encouraged to be posted in other languages predominant to the area as a safety and legal precaution.

**Figure 9:** Visitor Packet Map

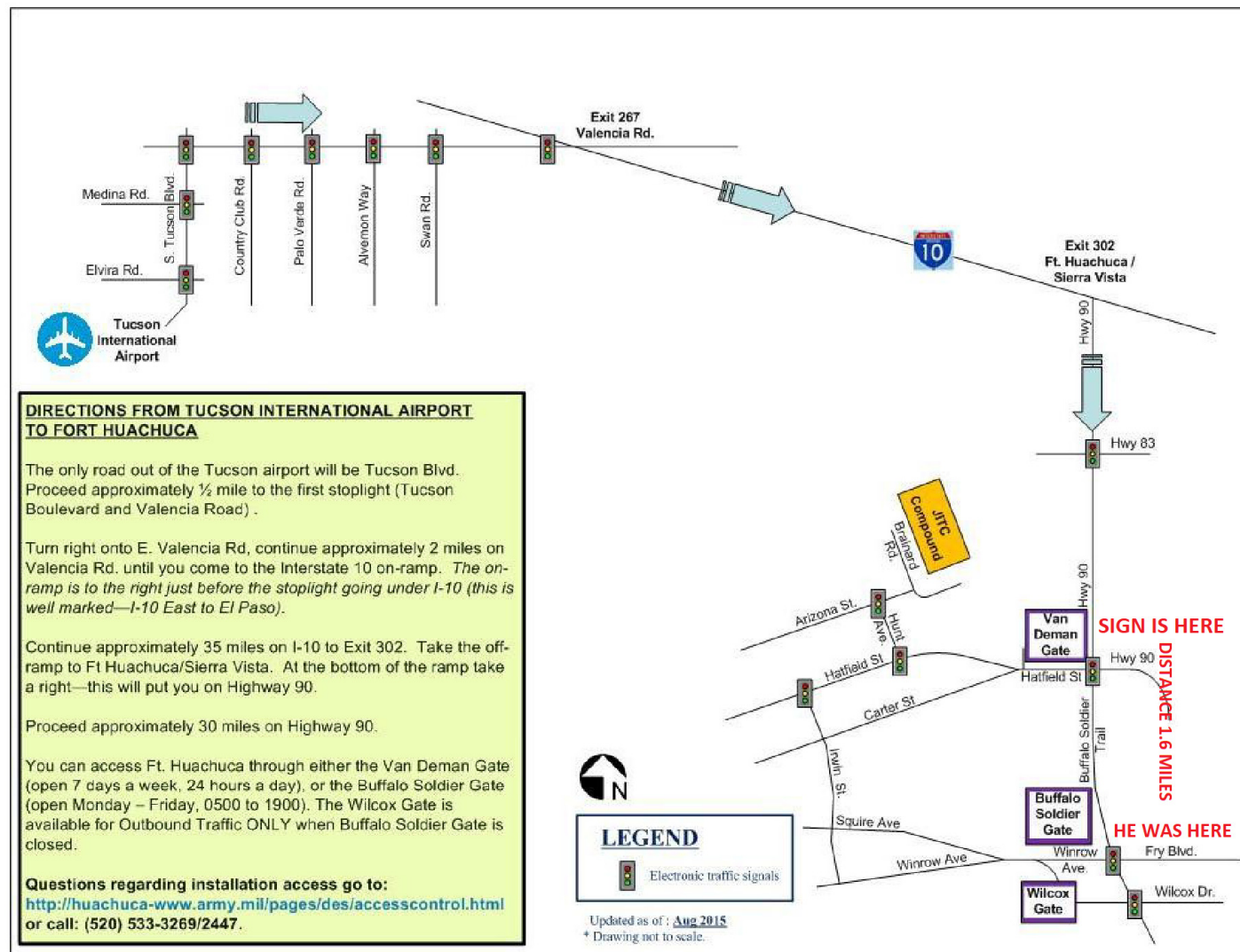

**Figure 10:** Distance from Buffalo Gate to Van Deman Gate, where the no photography sign is posted

11/10/2018

AZ-90, Sierra Vista, AZ 85635 to West Fry Boulevard & Winrow Avenue - Google Maps

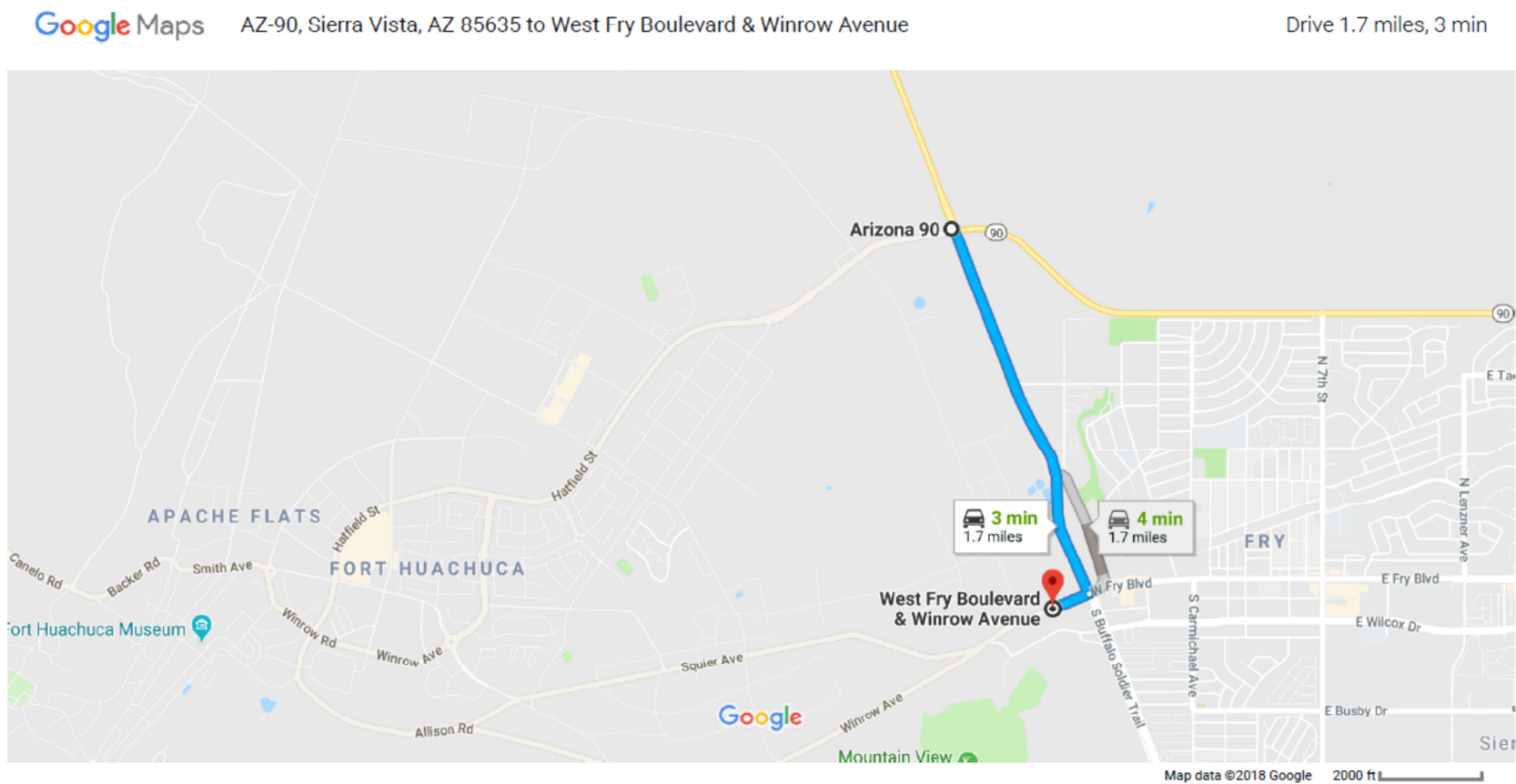

AZ-90  
Sierra Vista, AZ 85635